

Install Google Drive for Desktop

- Download the installer from: <https://www.google.com/drive/download/>
- Run the exe to install. You can opt to add a shortcut.

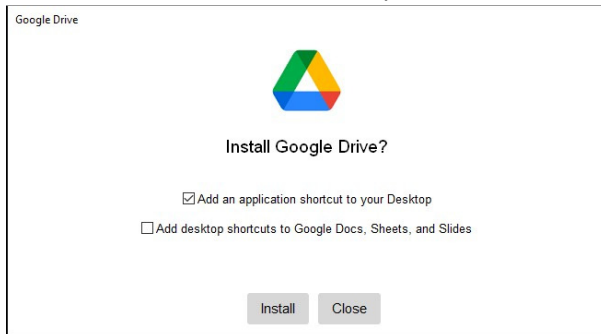

- You will be asked to sign in to Google Drive. One time.
Expect to see these dialogs.

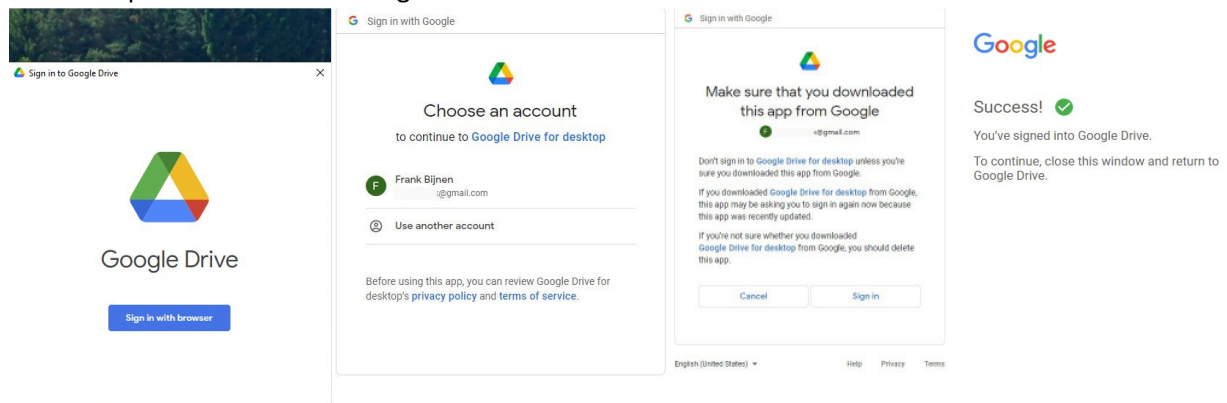

- You can start syncing a folder by right-clicking a folder in Windows Explorer, and click 'Sync or Backup this folder'. This is the folder where you save the exported GPX files from Basecamp, MRA, or any other program that you like. (For example: C:\MyData\BaseCamp) You only need to check 'Sync with Google Drive'.

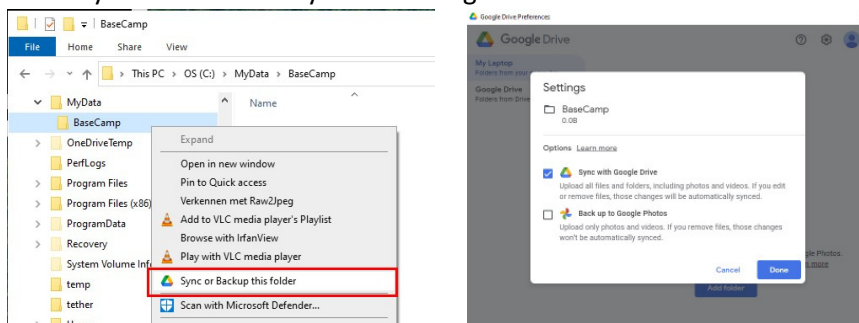

Warning:

Syncing works both ways. From Windows to Google Drive and vice versa. That means if you save a file in Windows, it will be synced to Google Drive. But also if you upload a file on your mobile device to Google Drive, it will be synced to your Windows.

Syncing also works for deletes. So if you delete a file from Windows or Google Drive, it will also be deleted in its counterpart.

I like to think that's a good thing, but you should be aware.

- To review the settings you can access Google Drive via the shortcut on your desktop, or the icon in the taskbar. Next click the sprocket, to access Preferences.

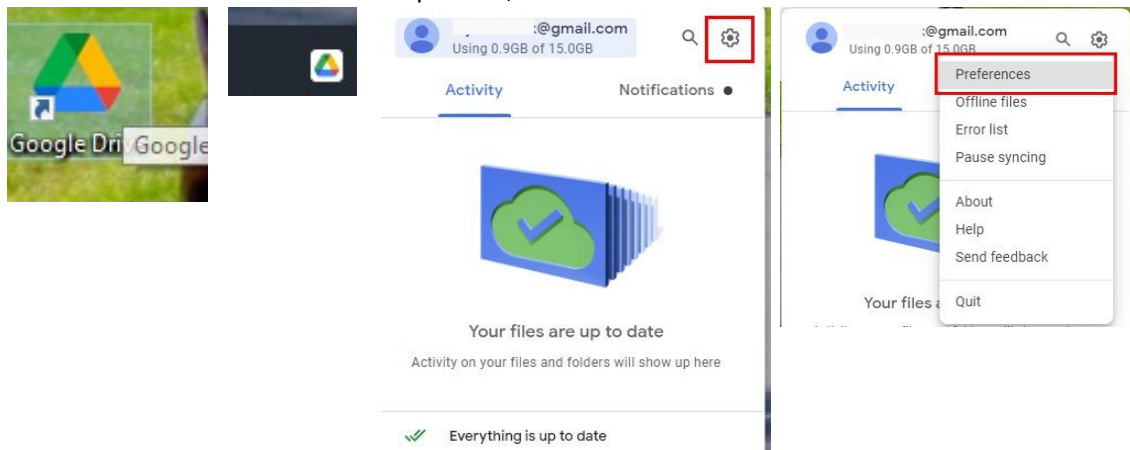

- Here you should see the folder you just setup for syncing.

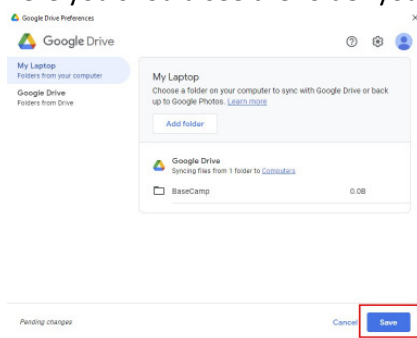

Sync from Windows to Google Drive

- Once Google Drive for Desktop has been installed, you are ready to export a GPX file. In this screenshot from Basecamp,

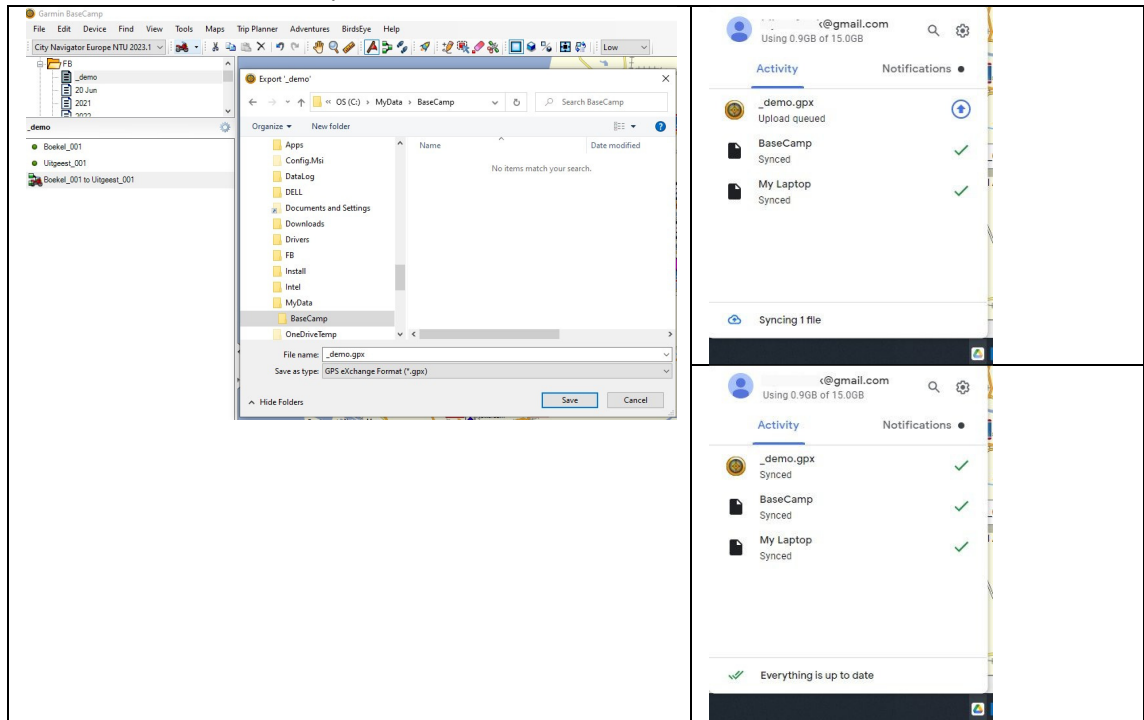

- After you press Save, you can see, if you have opened the icon in the Taskbar, 'Upload queued', followed by 'Synced'. The GPX is now available in Google Drive.
- I recommend adding a shortcut in Google Drive. That will make uploading a lot easier. Open <https://drive.google.com/drive/computers> in a browser. Screenshots are from Windows, but Android will work also.
 - o Find the computer. In this example 'My Laptop' and double click (I have 3 computers setup!)
 - o Locate the Folder. In this example 'BaseCamp' and right click.
 - o Choose 'My Drive'

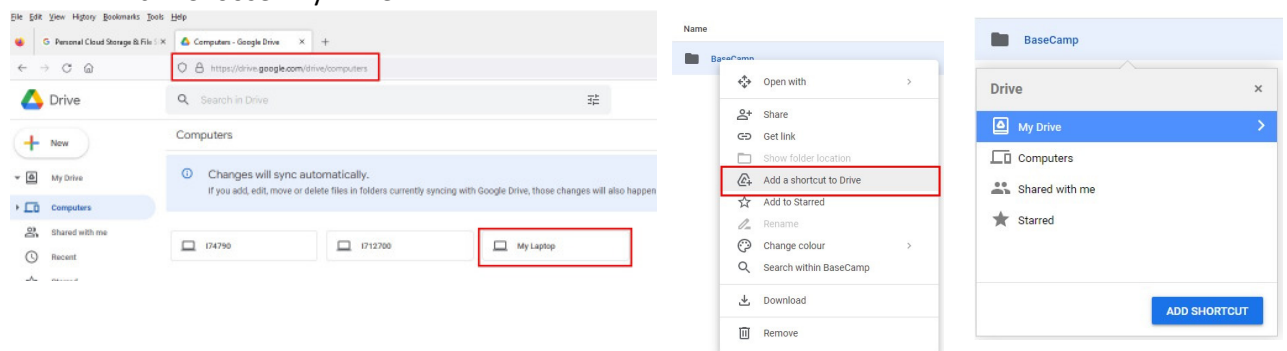

Google Drive on your Mobile (phone, tablet)

This document assumes that you have installed Google Drive and Garmin Drive on your mobile device.

You should use the same Email address that you use in Windows.

Connect the XT to Garmin Drive without setting up Garmin Explore.

The shortcuts 'Google Drive' and 'Garmin Drive' are both called 'Drive'. But have a different Icon. Confusing at the beginning!

Transfer TO the XT

Open Google Drive on your mobile.

Locate the GPX that you would like to send.

Click on it.

A dialog will appear 'Open with'. Choose 'Drive'. (That being Garmin Drive, not Google Drive)

Garmin Drive should pick it up and start sending it to the XT.

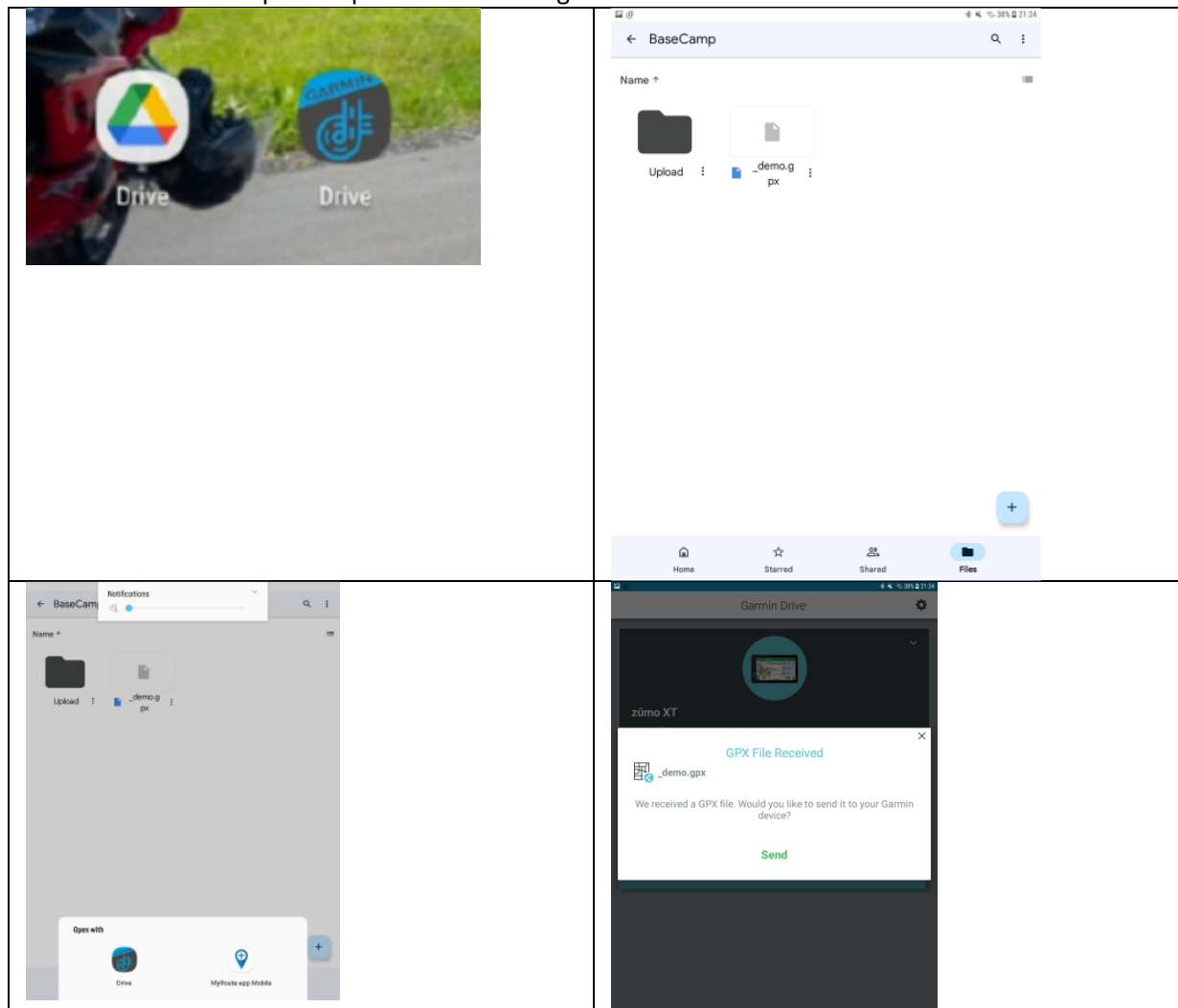

Transfer FROM the XT

You can also transfer Tracks, Trips and Saved places.

Important! Open the Garmin Drive app first on your Mobile, and keep the window visible. Else the mobile window where you click 'Share' will not appear and communication to the XT will hang.

XT: Locate the item that you would like to transfer. Hit the spanner!

Click 'Share', select the items to share. 'Sharing items to Garmin Drive app.'

For large tracklogs, trips, it can take a while to process.

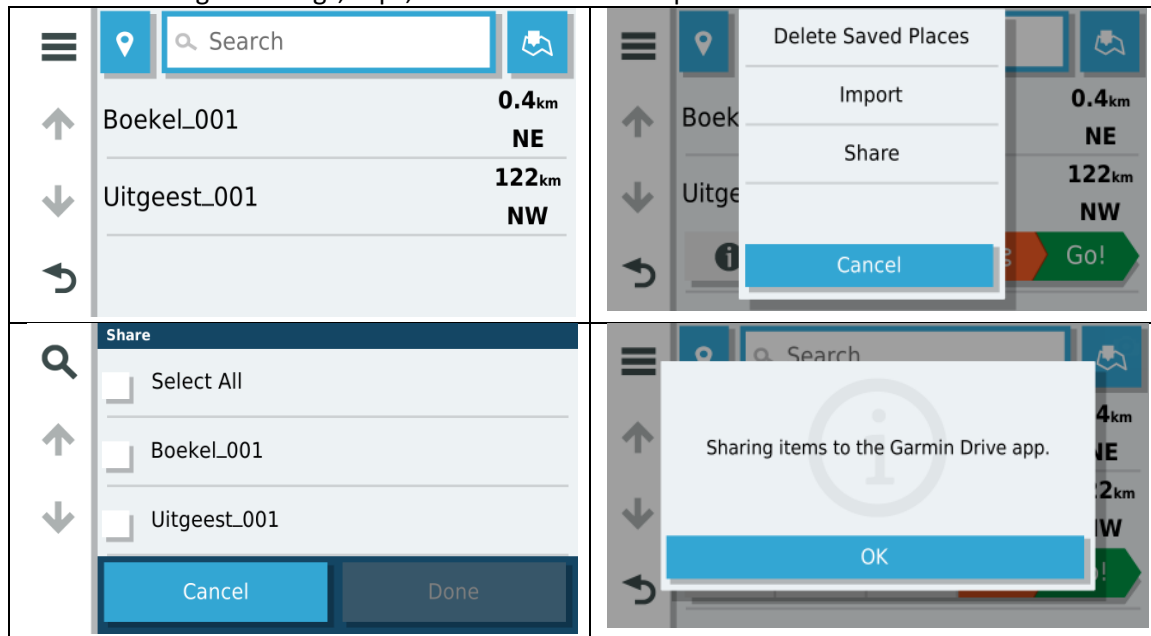

Mobile: Garmin Drive should pick it up. Click on Share.

Select Google Drive.

Choose a location to save. (Now the shortcut comes in handy)

Type a filename and click Save.

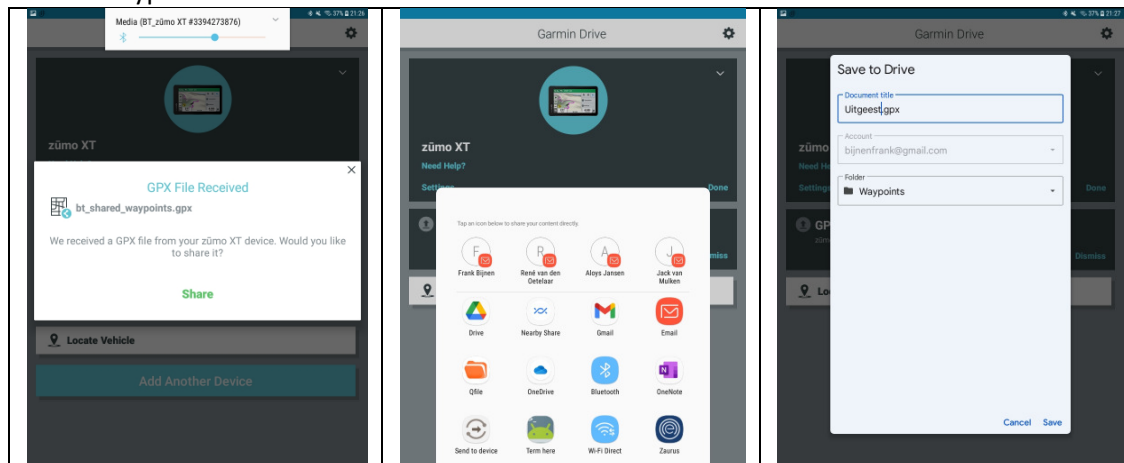

If your Windows is running, you will see the file appear in your folder. (e.g. C:\MyData\BaseCamp)

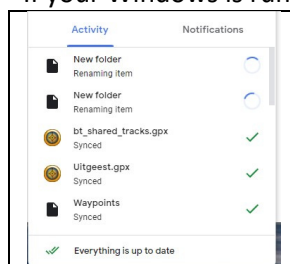

MyRoute APP

How does MRA fit in?

If you use MRA in a browser on Windows, you can use it like BaseCamp. E.g.: 'Save As' to your synced folder. 'Upload' from you synced folder.

If you use MRA on your mobile device, you can 'Upload', from 'Google Drive'. At first it looks OK, but after a while you will (at least I) get an error:

'Something went wrong while uploading your file. MyRoute-app couldn't read your file'.

As a work-around you can upload the GPX on Windows, or Download the GPX on your mobile from Google Drive to 'Downloads' on your Mobile. Then the Upload in MRA works from 'Downloads'.

Contrary 'Save as' from MRA to Google Drive works well. At some point you have to choose 'Share'.

So you can also use Google Drive to send/receive files to Basecamp, and the XT.

I haven't tested other apps, but likely they will work also.